

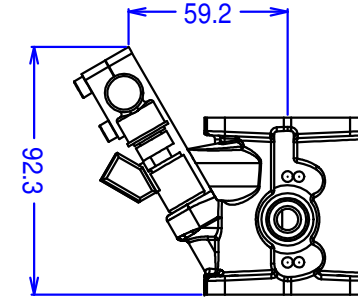

## SFE single bore throttle body

© Jenvey Dynamics Ltd 2000-2010  
Issue 3  
[www.jenvey.co.uk](http://www.jenvey.co.uk)

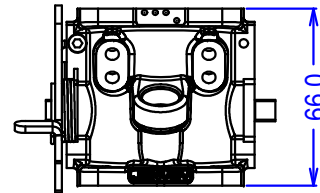
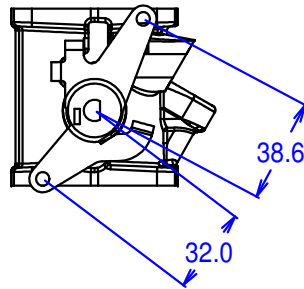
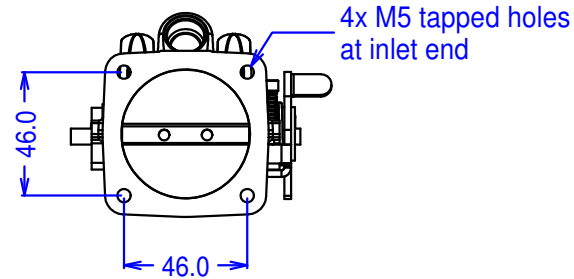

Measurements for Pico injector

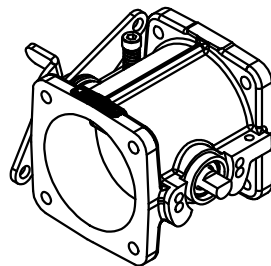

Non-injected body

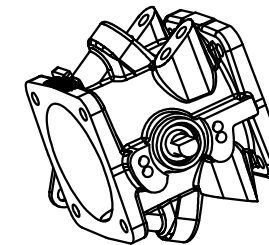
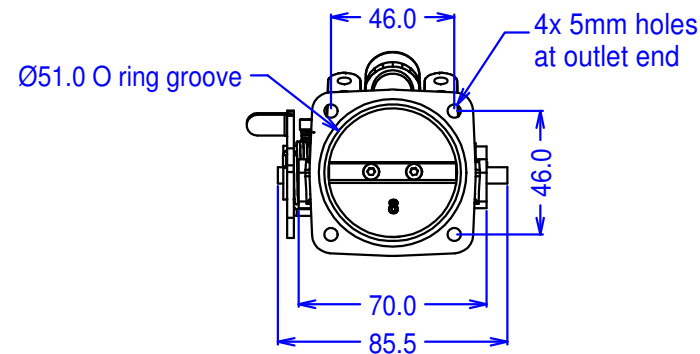

Twin injector body

The SFE body is the ultimate, no compromise fuel injection throttle body. It may be fitted any way up and at minimum centre distances of 63mm (not injected) or 86mm (injected) Sizes are; 40, 42, 45, 48 and 50mm, whilst tapered bore bodies are stocked with 42, 45 and 48mm butterfly sizes or may be CNC bored to any reasonable shape on request. It is available with 0, 1 or 2 injector positions. The popular sizes of suitable fuel rail are stocked, whilst others are made to order. Complete with right hand linkage (when ordering 1 body) or standard in-line interconnecting links when ordering a number of bodies. Alternative lever configurations are available.

Bodies come with 'O' rings for the outlet end and bungs for the inlet end.

Data; Spindle rotation: 82°. Torque per spindle at WOT: 110 - 120 N-mm giving a tangential pull of 2.9 - 3.1 N on long arm of standard lever. Option 310 N-mm springs available. Other items; Quadrant throttle mechanism, linkage kits, range of air horns (bellmouths, trumpets, stacks), throttle potentiometers.